

# HARDWARE & MISC

MICRO-D BACKSHELL  
45 DEGREE ROUND ENTRY

OMNETICS PART #:  
A97000-XXX

OPTION CODE:  
BS1

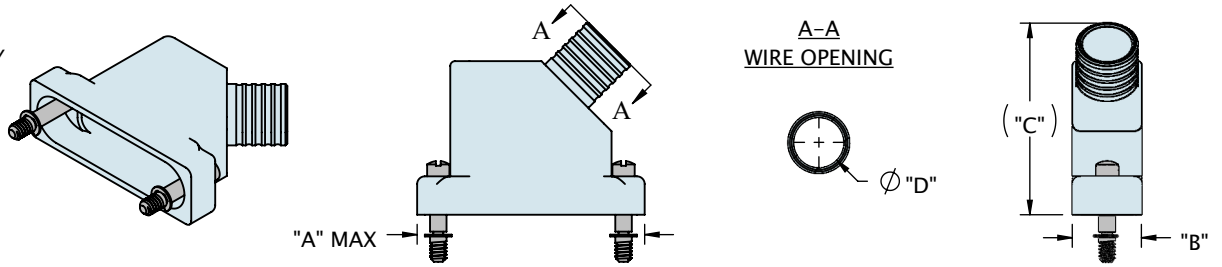

CONTACTS	ROWS	"A"	"B"	"C"	"D"
009	2	.785 [19.94]	.340 [8.64]	.848 [21.54]	.160 [4.06]
015	2	.935 [23.75]	.340 [8.64]	.898 [22.81]	.190 [4.83]
021	2	1.085 [27.56]	.340 [8.64]	.948 [24.08]	.220 [5.59]
025	2	1.185 [30.10]	.360 [9.14]	.998 [25.35]	.260 [6.60]
031	2	1.335 [33.91]	.360 [9.14]	1.038 [26.37]	.275 [6.99]
037	2	1.485 [37.72]	.360 [9.14]	1.078 [27.38]	.285 [7.24]
051	2	1.835 [46.61]	.413 [10.49]	1.078 [27.38]	.350 [8.89]
051	3	1.435 [36.45]	.413 [10.49]	1.160 [29.46]	.350 [8.89]
069	3	1.735 [44.07]	.473 [12.01]	1.160 [29.46]	.410 [10.41]

DIMENSIONS IN [ ] ARE IN MILLIMETERS AND ARE FOR REFERENCE ONLY

MICRO-D BACKSHELL  
STRAIGHT OVAL ENTRY

OMNETICS PART #:  
A97001-XXX

OPTION CODE:  
BS2

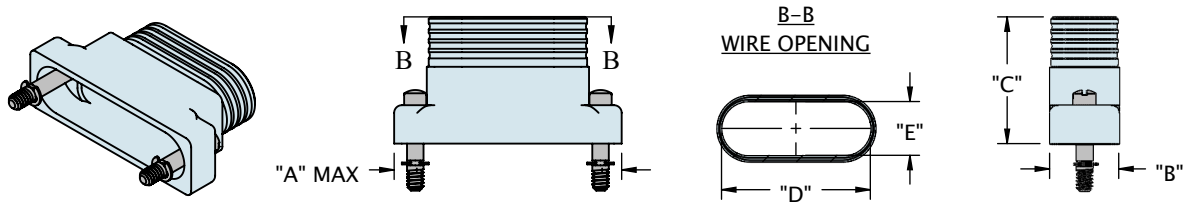

CONTACTS	ROWS	"A"	"B"	"C"	"D"	"E"
009	2	.785 [19.94]	.340 [8.64]	.66 [16.8]	.375 [9.53]	.280 [7.11]
015	2	.935 [23.75]	.340 [8.64]	.66 [16.8]	.525 [13.34]	.280 [7.11]
021	2	1.085 [27.56]	.340 [8.64]	.66 [16.8]	.675 [17.15]	.280 [7.11]
025	2	1.185 [30.10]	.360 [9.14]	.66 [16.8]	.775 [19.69]	.280 [7.11]
031	2	1.335 [33.91]	.360 [9.14]	.66 [16.8]	.925 [23.50]	.280 [7.11]
037	2	1.485 [37.72]	.360 [9.14]	.66 [16.8]	1.075 [27.31]	.280 [7.11]
051	2	1.835 [46.61]	.360 [9.14]	.66 [16.8]	1.425 [36.20]	.280 [7.11]
051	3	1.435 [36.45]	.380 [9.65]	.88 [22.4]	1.025 [26.04]	.320 [8.13]
069	3	1.735 [44.07]	.380 [9.65]	.88 [22.4]	1.325 [33.66]	.320 [8.13]
100	4	2.170 [55.12]	.423 [10.74]	.88 [22.4]	1.480 [37.59]	.363 [9.22]

DIMENSIONS IN [ ] ARE IN MILLIMETERS AND ARE FOR REFERENCE ONLY

MICRO-D BACKSHELL  
90 DEGREE OVAL ENTRY

OMNETICS PART #:  
A97002-XXX

OPTION CODE:  
BS3

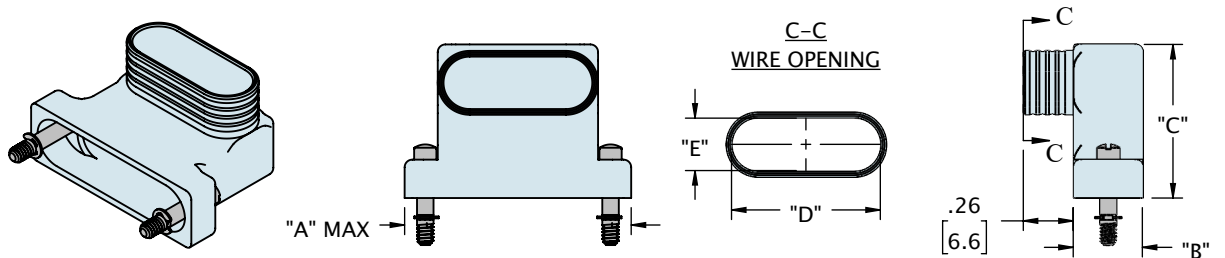

CONTACTS	ROWS	"A"	"B"	"C"	"D"	"E"
009	2	.785 [19.94]	.340 [8.64]	.80 [20.3]	.375 [9.53]	.273 [6.93]
015	2	.935 [23.75]	.340 [8.64]	.80 [20.3]	.525 [13.34]	.273 [6.93]
021	2	1.085 [27.56]	.340 [8.64]	.80 [20.3]	.675 [17.15]	.273 [6.93]
025	2	1.185 [30.10]	.360 [9.14]	.80 [20.3]	.775 [19.69]	.273 [6.93]
031	2	1.335 [33.91]	.360 [9.14]	.80 [20.3]	.925 [23.50]	.273 [6.93]
037	2	1.485 [37.72]	.360 [9.14]	.80 [20.3]	1.075 [27.31]	.273 [6.93]
051	2	1.835 [46.61]	.360 [9.14]	.80 [20.3]	1.425 [36.20]	.273 [6.93]
051	3	1.435 [36.45]	.400 [10.16]	1.00 [25.4]	1.025 [26.04]	.313 [7.95]
069	3	1.735 [44.07]	.400 [10.16]	1.00 [25.4]	1.325 [33.66]	.313 [7.95]

DIMENSIONS IN [ ] ARE IN MILLIMETERS AND ARE FOR REFERENCE ONLY