

**MATERIALS & SPECIFICATIONS**

HOUSING: ALUMINUM 6061-T6, NICKEL PLATE  
PER AMS-C-26074

INSULATOR: LIQUID CRYSTAL POLYMER (LCP)  
PER ASTM D5138

CONTACT: COPPER ALLOY PER MIL-DTL-83513,  
GOLD PLATED PER ASTM B488,  
(HARD GOLD) TYPE II CODE C  
CLASS 1.27

TERMINATIONS: COATED WITH SN63A PER J-STD-006

CURRENT RATING 1 AMP MAX

CONTACT RESISTANCE 25 MILLIOHM MAX

PERFORMANCE: PRODUCT FAMILY TESTED TO  
AND PASSED THE PERFORMANCE  
SPECIFICATIONS OF TABLE VIII  
OF MIL-DTL-32139

PART NO.	REV	ECO	DATE	APP
	E	94450	05-14-07	TLM

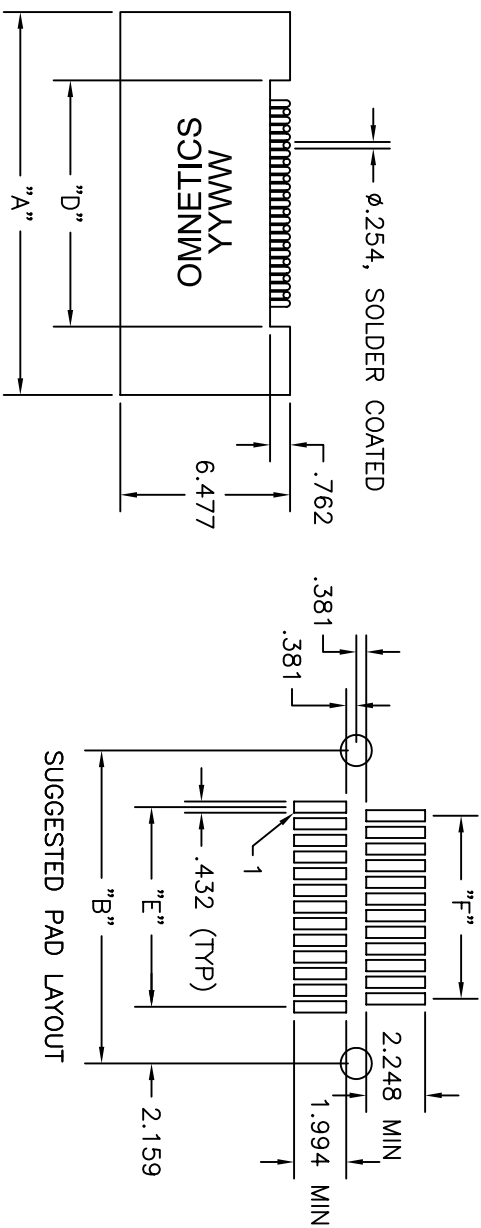

**METRIC**

2X #0-80 UNF-2B

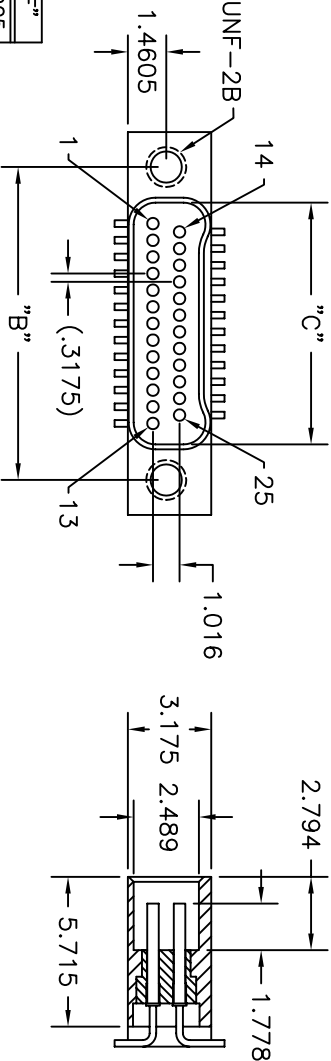

(SHOWN)

PART NO.	CONTACTS	"A"	"B"	"C"	"D"	"E"	"F"
A29200-009	9	9.525	6.858	4.140	4.318	2.540	1.905
A29200-015	15	11.430	8.763	6.045	6.223	4.445	3.810
A29200-021	21	13.335	10.668	7.950	8.128	6.350	5.715
A29200-025	25	14.605	11.938	9.220	9.398	7.620	6.985
A29200-031	31	16.510	13.843	11.125	11.303	9.525	8.890
A29200-037	37	18.415	15.748	13.030	13.208	11.430	10.795
A29200-051	51	22.860	20.193	17.475	17.653	15.875	15.240
A29200-065	65	27.305	24.638	21.920	22.098	20.320	19.685

-TOLERANCES-		<b>OMNETICS CONNECTOR CORPORATION</b>		CAGE CODE <b>61873</b>	
UNLESS OTHERWISE NOTED		DATE		DWG NO.	
DIMENSIONS IN MILLIMETERS		DATE		<b>A29200-0XX</b>	
2 PL DEC	± .25	DFTM. PER	DATE	TITLE:	
3 PL DEC	± .127	CHK'D.	DATE	(XX) SOCKET FEMALE	
4 PL DEC	±	APP'D.	DATE	BI-LOBE CONNECTOR	
ANGLES	±			SCALE: 5:1	
MNSO				SHEET 1 OF 1	
				REV E	